



inverter com Off Grid Solar Inverter Wifi Plug Pro Installation Guide

[Home](#) » [inverter.com](#) » inverter com Off Grid Solar Inverter Wifi Plug Pro Installation Guide 

inverter.com

Off Grid Solar Inverter WIFI Plug Pro



Installation Guide

Contents

- [1 Off Grid Solar Inverter Wifi Plug Pro](#)
- [2 Installation](#)
- [3 Wireless Router Connection](#)
- [4 Create Account And Plant](#)
- [5 Documents / Resources](#)
- [6 Related Posts](#)

Off Grid Solar Inverter Wifi Plug Pro

 iOS	 Android
http://itunes.apple.com/cn/app/smartclient-for-solar/id1070155085?l=en&mt=8	https://play.google.com/store/apps/details?id=com.eybond.smartclient

Installation

- ① Align the serial port of the Wi-Fi Plug Pro with the inverter and plug it in tightly.
- ② Fasten the Wi-Fi Plug Pro to the inverter with the screw.
- ③ Confirm the status of the LED indicator (After step2.3, when 4 LED indicators keep on, showing the normal working status).

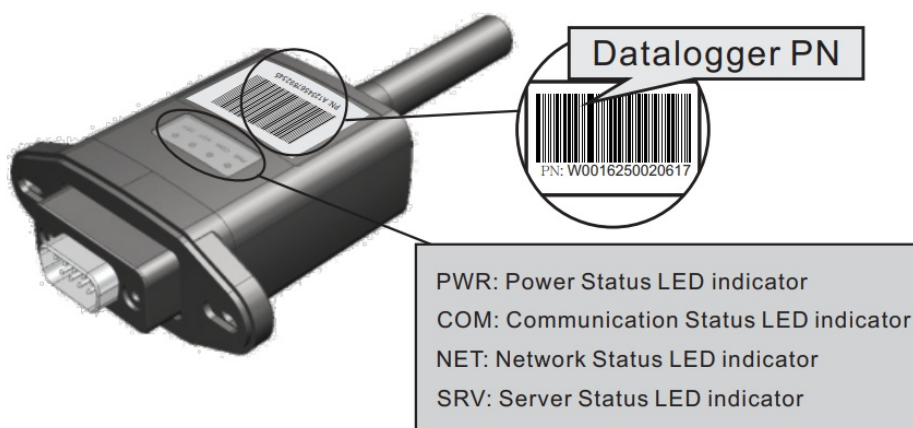

Wireless Router Connection

2.1 Download APP and Wi-Fi connection

- ① Scan the QR Code from the cover of this guideline and download the APP.
- ② Select the same number of Wi-Fi Plug Pro PN to connect on your phone WLAN.
(Initial Password:12345678)

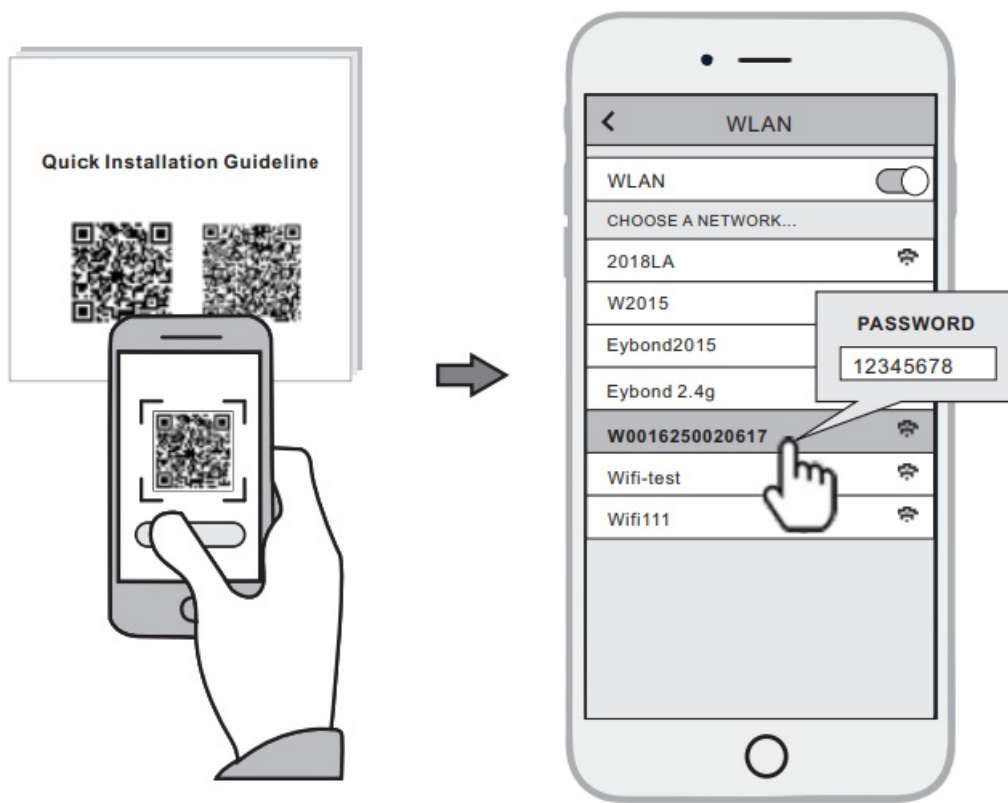

2.2 Wi-Fi Config

- ① Open the APP, Tap the Wi-Fi Config button to enter this page.
- ② Then tap the Network Setting button.

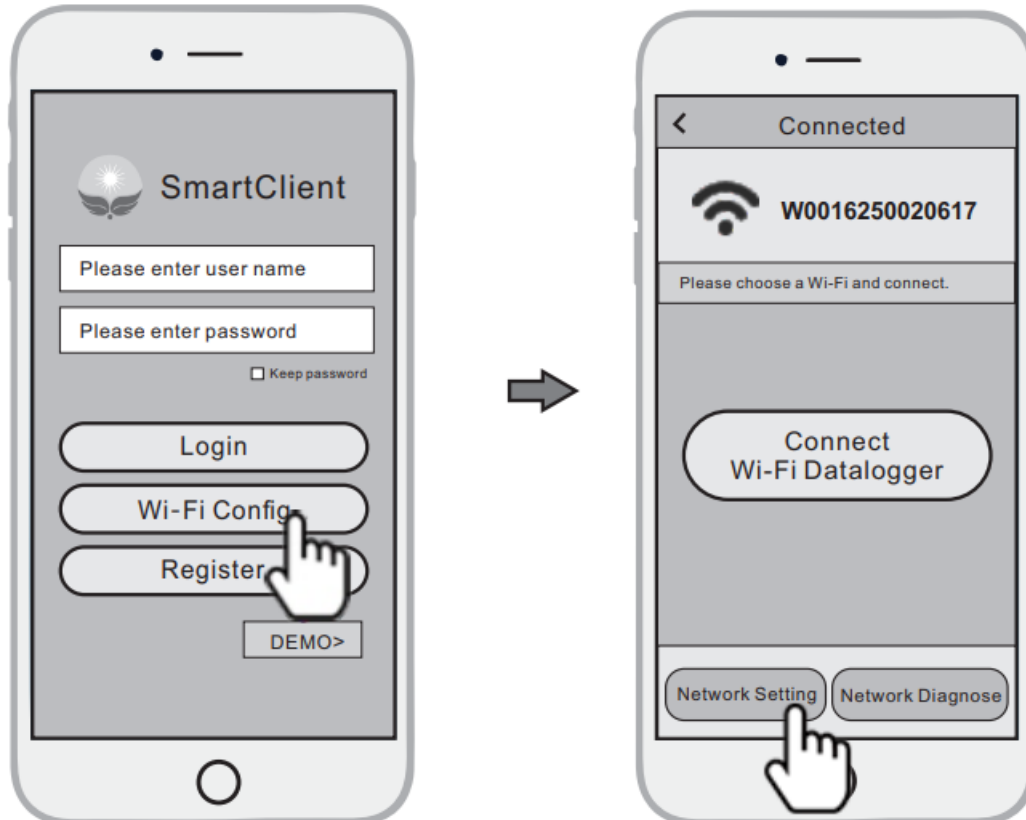

2.3 Network Setting

- ① According to the prompts, type in the information to finish the network setting.
- ② After the Wi-Fi Plug Pro is restarted, reconnect the Wi-Fi which connected by step 2.1.

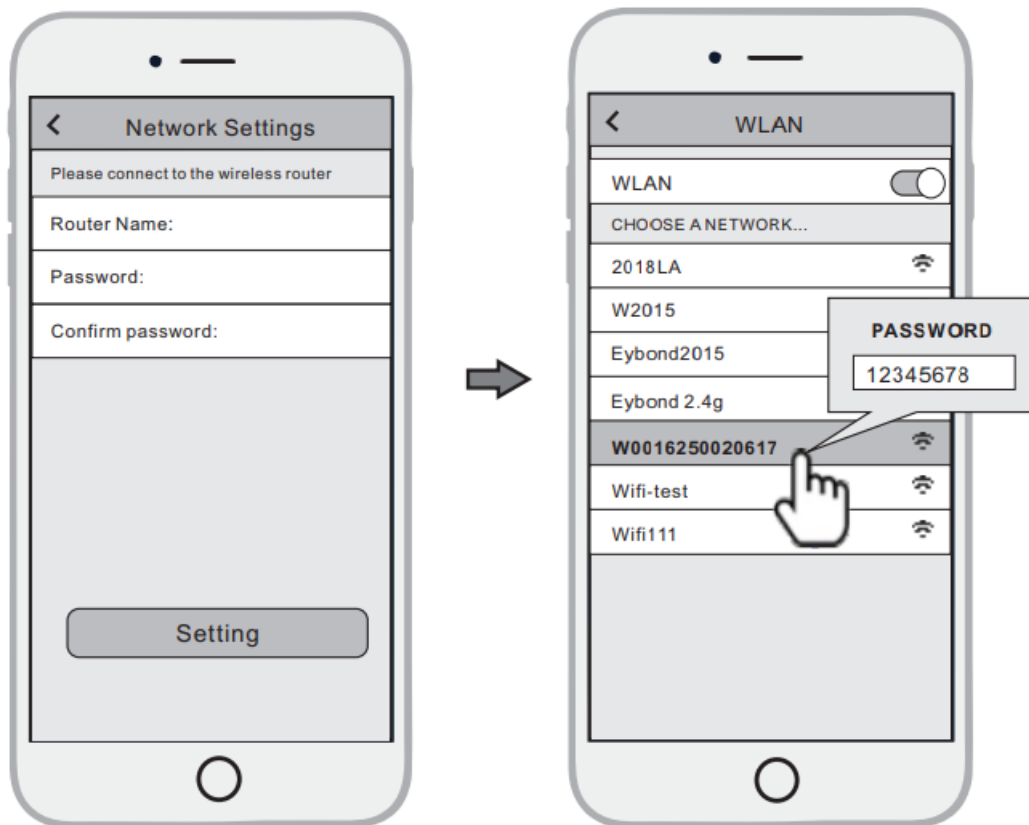

Create Account And Plant

3.1 Create Account

- ① Open the APP, tap the Register button.
- ② According to the prompt information, complete creating an account.

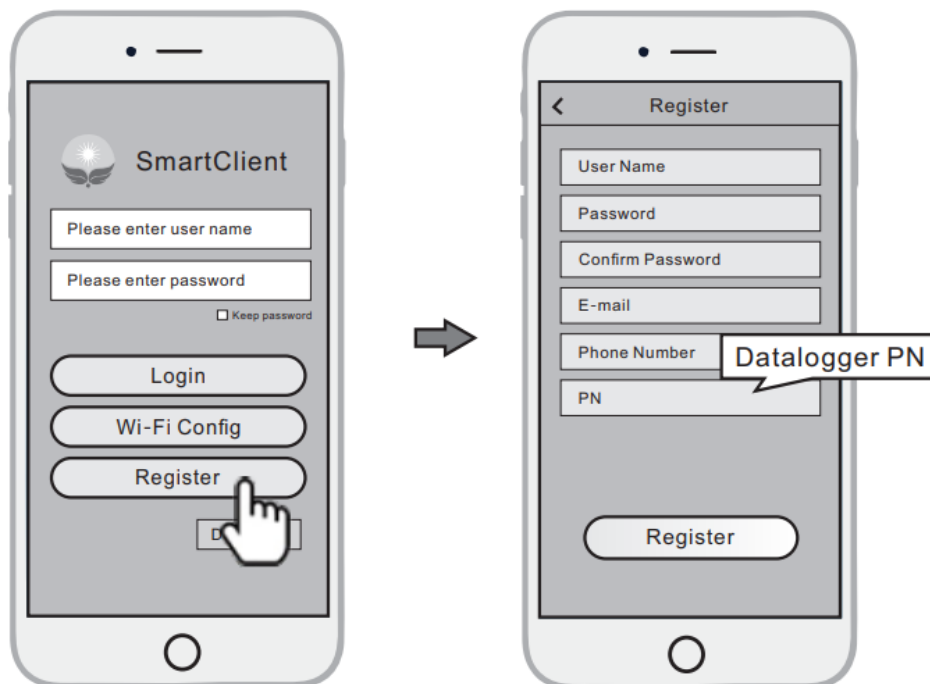

3.2 Create Plant

- ① Login the account and click the list button on the bottom of the home page.
- ② Tap the “ ” button on the top-right corner of the list page.
- ③ According to the prompts, type in the information to finish creating plant.

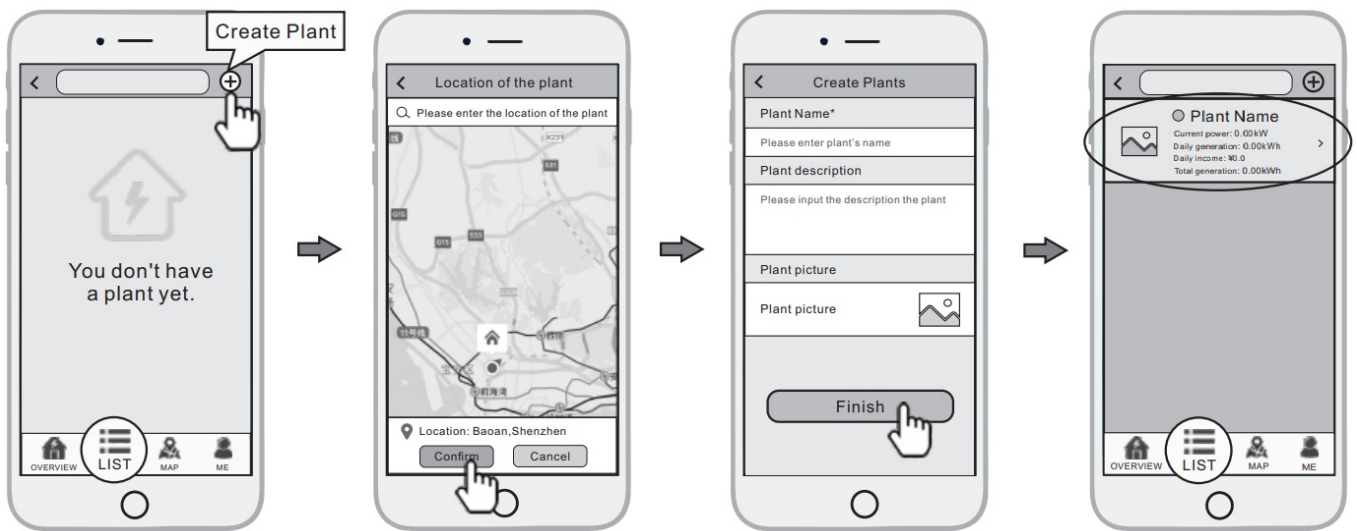

3.3 Add Multiple Dataloggers

Note: One account can create multiple plants and one plant can add multiple dataloggers. If you only have one datalogger, you can ignore this step.

- ① Tap the new plant you just created, and enter its home page.
- ② Click the Device button on the bottom of the home page.
- ③ Tap the “+” button at the top-right corner to add the datalogger.
- ④ Scan the datalogger PN on the Wi-Fi Plug Pro, or input it manually.

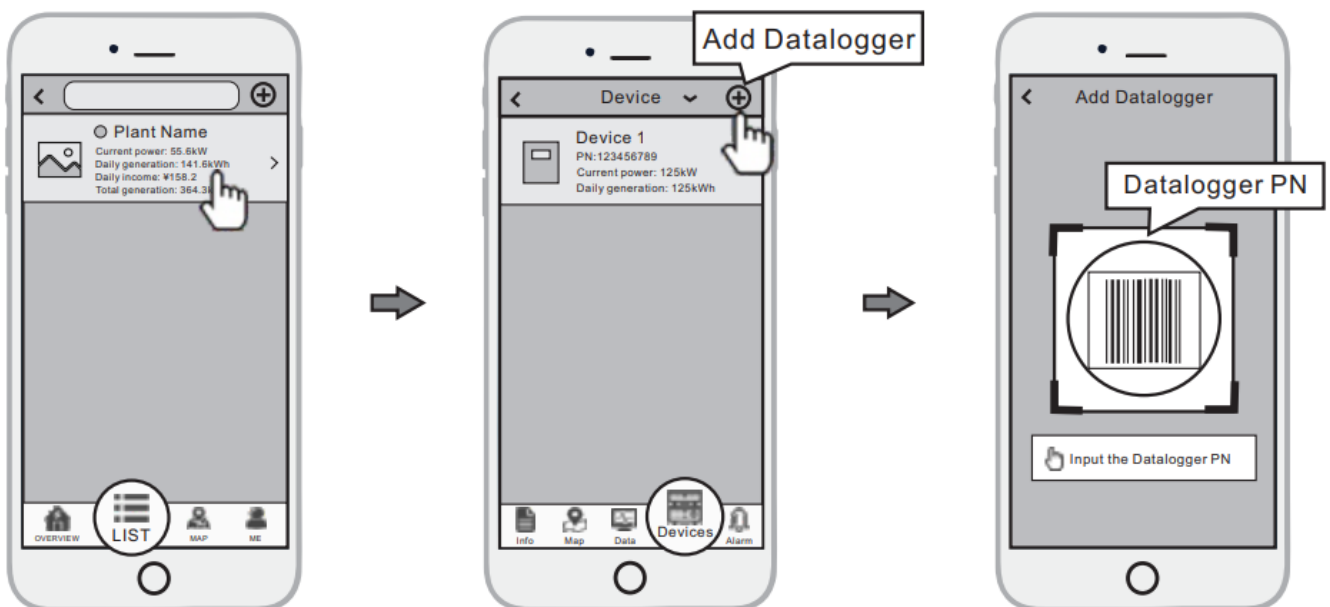

Note: Besides the Smart Client APP, you also can remote monitoring your plants by using WeChat mini program.



Scan the WeChat QR code to use the mini program.

inverter.com

Documents / Resources



[inverter.com Off Grid Solar Inverter Wifi Plug Pro](#) [pdf] Installation Guide
Off Grid Solar Inverter Wifi Plug Pro, Grid Solar Inverter Wifi Plug Pro, Solar Inverter Wifi Plug Pro, Inverter Wifi Plug Pro, Wifi Plug Pro, Plug Pro, Pro

Manuals+